

HSF

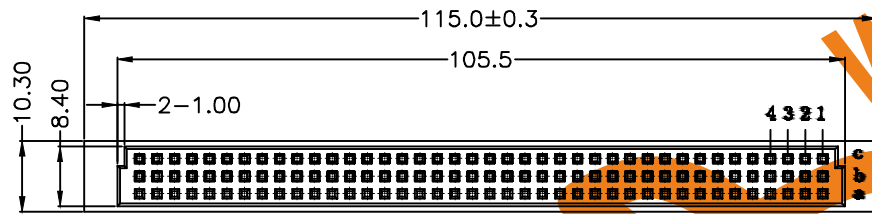

ROHS

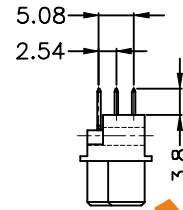
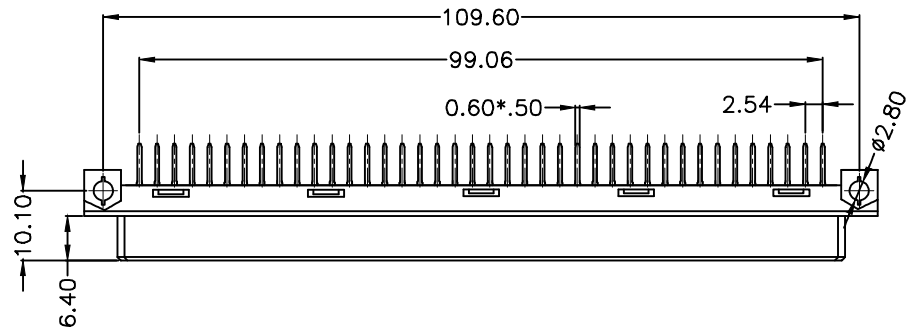

RECOMMENDED PCB LAYOUT

SPECIFICATIONS:

1. Material And Plating:

1.1 Housing: PBT+5%PC UL94V-0

1.2 Contacts: Phosphor bronze

1.3 Contact Plating:

G=Gold flash plated all over, Ni under plated all over

T=Tin plated all over, Ni under plated all over

S=Gold flash plated on contact area, Tin PLATED ON

SOLDER TAIL, Ni under plated all over

2. Electronical Characteristic:

2.1 Current rating: 2 AMPS

2.2 Contact resistance: 20 mohms

2.3 Insulation resistance: 1000 mohms min@500V DC

2.4 Dielectric withstanding voltage: 1000V AC/minute

Ordering Code:

DFS - 120 - A - J - X - 501

① ② ③ ④ ⑤

① Series No:

⑤ Contact Plating

- G0: Gold flash
- S0: Gold flash/Ni
- G1: 3u" Gold
- S1: 3u" Gold/Ni
- G2: 5u" Gold
- S2: 5u" Gold/Ni
- G3: 10u" Gold
- S3: 10u" Gold/Ni
- G4: 15u" Gold
- S4: 15u" Gold/Ni
- G5: 30u" Gold
- S5: 30u" Gold/Ni
- SN: Tin

② No. of Contacts  
120P

③ Termination  
A: Straight tail length  
H=3.8mm

④ Rows Loaded With Contacts  
J: Row a+b+c

Unless Otherwise specified tolerance



WWW.AsA-Elec.com  
AsA Electronic Co.  
Tel : (+98) 21 66 73 56 82 Mob : (+98) 912 03 161 02

SCALE: As Shown UNIT: mm

DRAW Robin DATE 05/14/2015

CHECK BobYang DATE 05/14/2015

TITLE: Vertical Female Type S Connectors  
120 Positions

DRAWING NO: DFS-120-AJX-501

PRODUCT NO: DFS-120-AJX-501

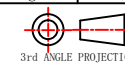

REV	DESCRIPTION	DATE
1		
2		
3		
4		
5		